

## IPRM - High precision analog sensors

dimension drawing

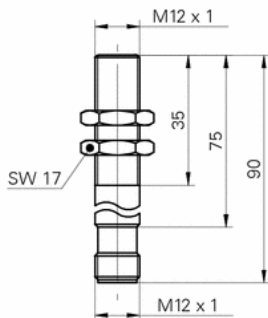

photo



pin assignment

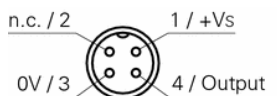

connection diagram

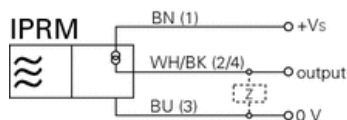

### general data

mounting type	quasi shielded
measuring speed	< 1 mm / ms
measuring distance Sd	0 ... 2 mm
resolution	< 0,0001 mm
linearity error	± 60 µm
repeat accuracy S = 0 ... 1 mm	< 1 µm
repeat accuracy S = 0 ... 2 mm	< 5 µm
temperature drift S = 0 ... 1 mm	± 10 µm
temperature drift S = 1 ... 2 mm	± 40 µm

### electrical data

voltage supply range +Vs	12 ... 30 VDC
current consumption max.	20 mA
output circuit	current output
output signal	0 ... 20 mA
load resistance +Vs min.	< 100 Ohm
load resistance +Vs max.	< 330 Ohm
zero point offset	< 0,3 mA
voltage drop Vd	< 7 VDC
short circuit protection	yes
reverse polarity protection	yes

### mechanical data

connection types	connector M12
type	cylindrical threaded
dimension	12 mm
housing length	90 mm
housing material	steel (9 SMn (Pb) 28/36)

### ambient conditions

operating temperature	0 ... +60 °C
protection class	IP 67